



# Draycott Close

Abington Vale, Northampton

oriordanbond  
SALES & LETTINGS



GROUND FLOOR  
586 sq.ft. (54.5 sq.m.) approx.

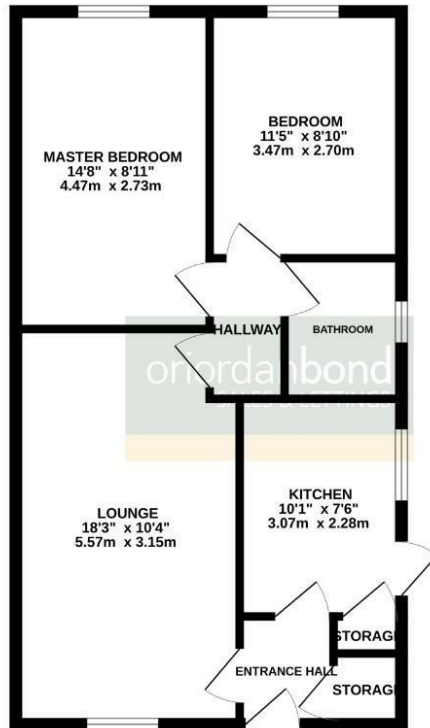

TOTAL FLOOR AREA : 586 sq.ft. (54.5 sq.m.) approx.  
Whilst every attempt has been made to ensure the accuracy of the floorplan contained herein, measurements of doors, windows, rooms and any other items are approximate and no responsibility is taken for any error, omission or misstatement. This plan is for illustrative purposes only and should be used as such by any prospective purchaser. The services, systems and appliances shown have not been tested and no guarantee as to their operability or efficiency can be given.  
Made with Hozomek C2025

## Draycott Close

Abington Vale

NN3 3BD

PRICE £240,000

A well presented two bedroom semi-detached bungalow, situated in this well regarded cul-de-sac, within the ever popular Abington Vale area of Northampton.

Having been much improved by the current owner, the property is offered for sale with accommodation comprising entrance hall, sitting room, re-fitted kitchen, inner lobby, two double bedrooms and a re-fitted shower room. Outside there are front and generous rear gardens and a driveway providing off road parking leading to a gated carport. Further benefits include gas radiator heating and uPVC double glazing. (B/586/L)

### Additional information

- Council Tax Band: C
- Energy Efficiency Rating: C

### Viewing

Viewing strictly by appointment – details below

### Disclaimer

O’Riordan Bond Estate Agents Limited has not tested apparatus, equipment, fittings or services and so cannot verify they are in working order. The buyer is advised to obtain verification from their solicitor or surveyor.

O’Riordan Bond Abington Vale Sales  
01604 639007

abingtonvale@oriordanbond.co.uk

